



FHC Series

SMD Flat Wire High Current Inductor

Size 1335

CHARACTERISTICS

-
-
-
- Quantity: 400pcs
- Magnetically shielded structure

APPLICATION

-
- High current DC/DC converter
- LC filter

Dimensions: [mm]

Land Pattern: [mm]

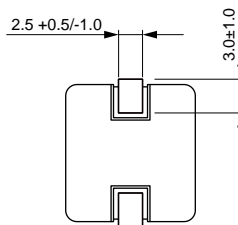
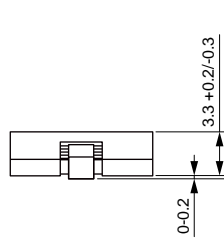
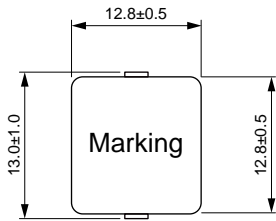

5.5

Electrical Properties:

Operating Temperature: -40 °C to +125 °C

Temperature Rise Current: the actual value of DC current when the temperature rise is T50C

Saturation Current that will cause initial inductance to drop approximately 30%



Typical Electrical Characteristics:

